

Technical proposal for JX-LCD2-30M4200M-30SF LC Duplexer

◆ High Performance

◆ High Reliability

Revision History

Version	Date	Author	Revision description	Comment
V1.0	2024/07/10	David.Pu	Created	/

Table of content

Technical proposal for JX-LCD2-30M4200M-30SF LC Duplexer	1
1. Mechanical layout	2
2. Electrical analysis	2

Figures

Figure 1 JX-LCD2-30M4200M-30SF front panel layout	2
Figure 2 The simulation curve of the filter	3

Tables

Table 1 Mechanical specifications @ JX-LCD2-30M4200M-30SF	2
Table 2 Electrical specifications @ JX-LCD2-30M4200M-30SF	2

JING XIN MICROWAVE TECHNOLOGY CO.,LTD

E-mail: sales@cdjx-mw.com Web: <http://www.cdjx-mw.com>

TEL: +86-28-85026087 FAX: +86-28-65026087 ext.8033 Zip Code:610045

Add: No.65,West 1st Wu Ke Road, Wu Hou District, Cheng Du City, Si Chuan Province, China.

1. Mechanical layout

Table 1 Mechanical specifications @ JX-LCD2-30M4200M-30SF

Dimension	L x W x H: 40 x 30 x 15mm
Connector	SMA-Female
Surface Finish	Conductive oxidation
Notes	Material shall be RoHS 6/6

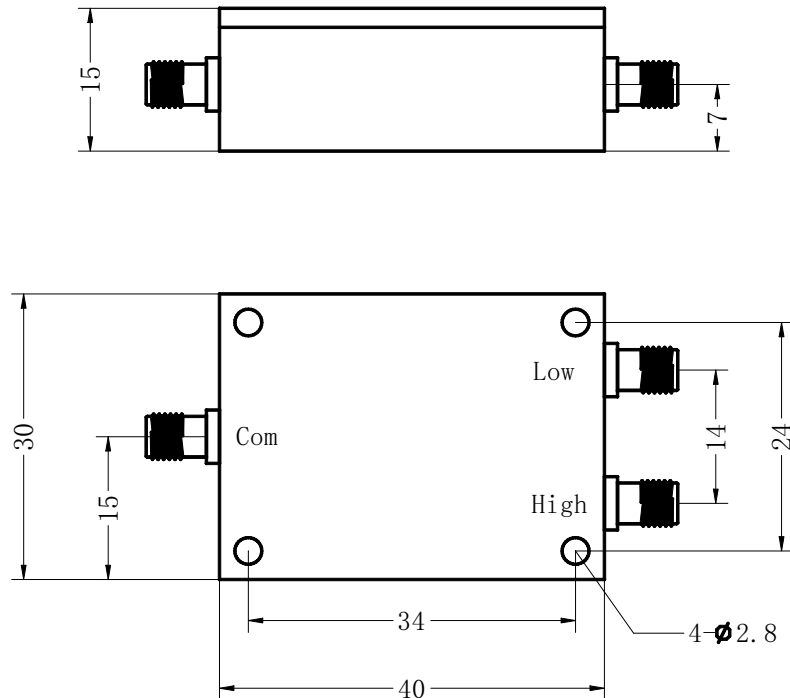

Figure 1 JX-LCD2-30M4200M-30SF front panel layout

2. Electrical analysis

Table 2 Electrical specifications @ JX-LCD2-30M4200M-30SF

Item	Parameter	Low	High
1	Frequency range	30-500MHz	703-4200MHz
2	Insertion Loss	≤ 1.0 dB	
3	Return loss	≥ 12 dB	
4	Rejection	≥ 30 dB	
5	Impedance	50 Ohms	
6	Average power	4W	
7	Peak power	6W	

JING XIN MICROWAVE TECHNOLOGY CO.,LTD

E-mail: sales@cdjx-mw.com Web: <http://www.cdjx-mw.com>

TEL: +86-28-85026087 FAX: +86-28-65026087 ext.8033 Zip Code:610045

Add: No.65,West 1st Wu Ke Road, Wu Hou District, Cheng Du City, Si Chuan Province, China.

8	Operation Temperature	-25°C to 65°C
---	-----------------------	---------------

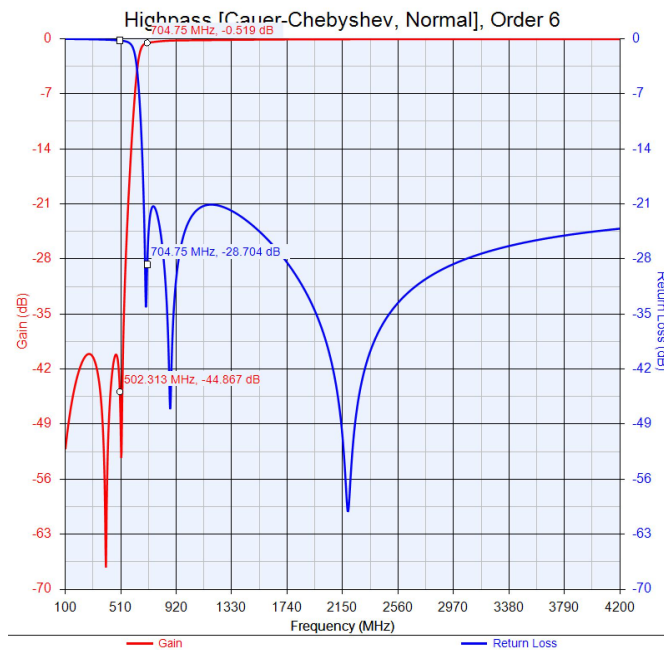
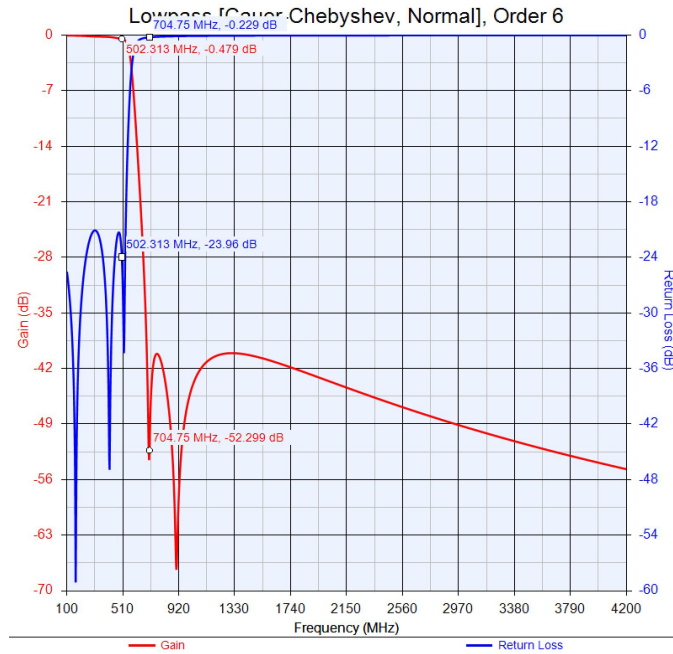

Figure 2 The simulation curve of the filter

JING XIN MICROWAVE TECHNOLOGY CO.,LTD

E-mail: sales@cdjx-mw.com Web: <http://www.cdjx-mw.com>

TEL: +86-28-85026087 FAX: +86-28-65026087 ext.8033 Zip Code:610045

Add: No.65,West 1st Wu Ke Road, Wu Hou District, Cheng Du City, Si Chuan Province, China.